

Frame

P A S T O E

pastoe rotsoord 3 po box 2152
3500 gd utrecht holland
tel +31 30 258 55 55 fax +31 30 252 23 40
info@pastoe.com www.pastoe.com

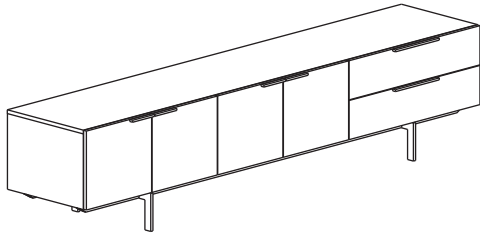

supplies

A/B

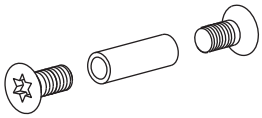

bolt and bush

Quantity

C

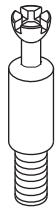

minifix-pin

quantity

D



dowel Ø5 x 30

E

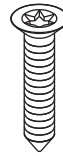

screw Ø4 x 20

quantity

F

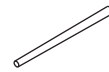

conical pin / lacquer touch-up

quantity

G

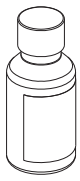

assembly instructions

1

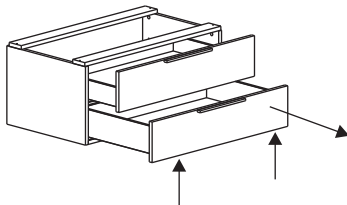

Remove the drawers, if present. To do this, grip the snappers on the underside of the drawer and pull it forward.

2

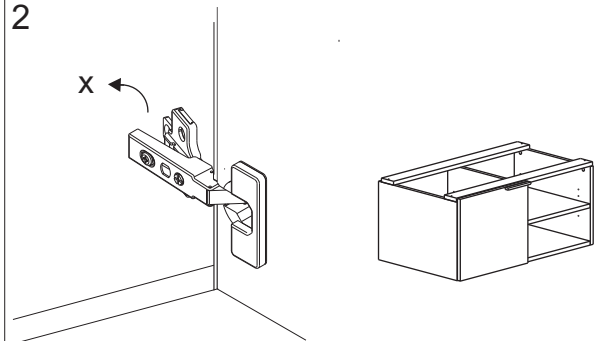

Remove the doors, if present. Remove the hinge from the panel. Do this by pulling lip x at the rear of the hinge forward. First, remove the damper.

3

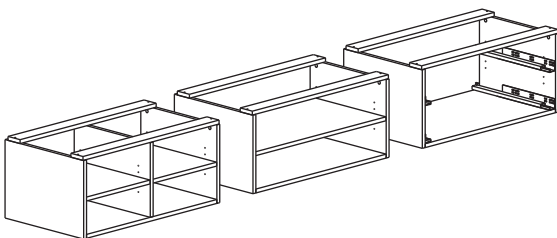

Place the bodies in the correct order at a short distance from each other.

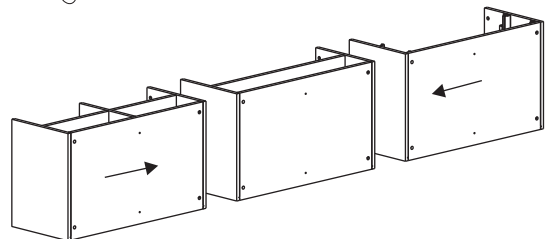
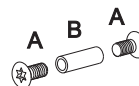

Rotate the bodies 90 degrees with the back to the ground. Couple the bodies with bolt A and bush B.

5

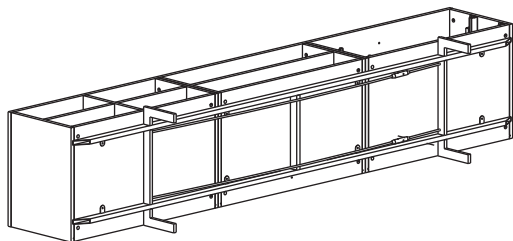

Use the screws (E) to connect the frame to the coupled bodies. Rotate the cupboard back on its frame.

6

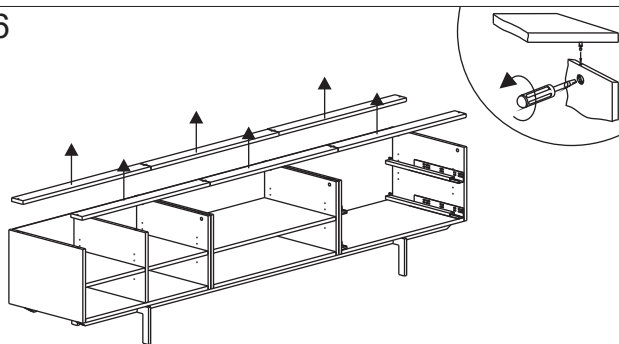

Dismount the transport laths by a half turn of the minifix-bush. Screw the minifix-pins out of the transport laths.

7

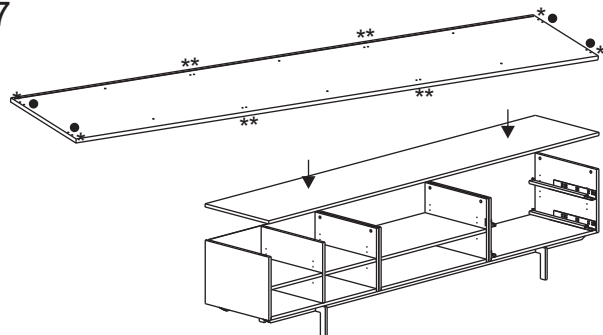

Place the minifix-pins C (see *) and dowels D (see ●) into the finishing top. Place the finishing top on the bodies and fix them by a half turn of the minifix-bush.

8

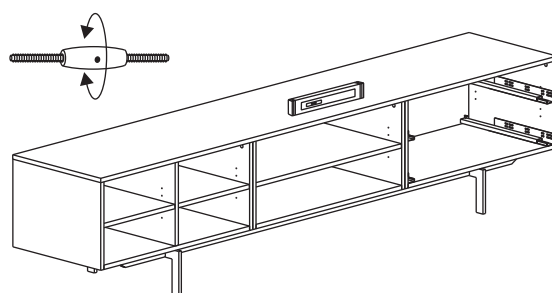

Place the cabinet in the desired position and level it by turning the adjustable feet by using the conical pin. To prevent the sideboard sagging under excessive loads, tighten the turnbuckles under the sideboard.

9

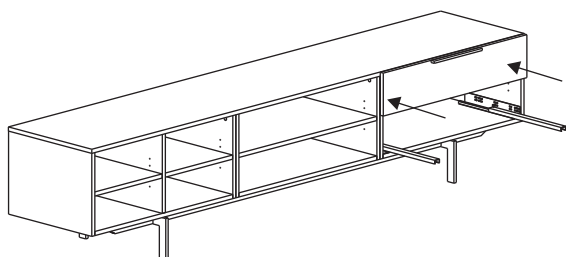

Place the drawers. To do this, pull the drawer runners out, place the drawers on them and slide them back in.

10

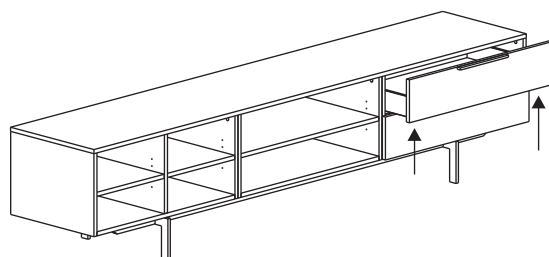

If necessary, the height of the drawer can be adjusted by means of the wedges underneath the drawer.

11

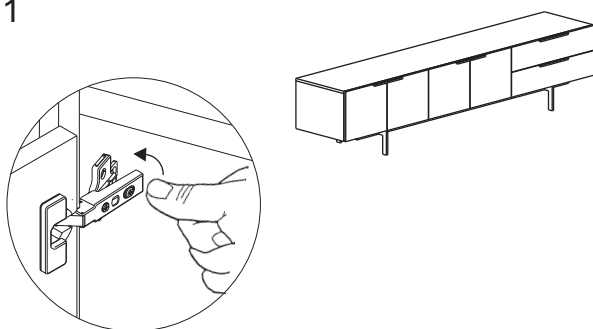

Replace the doors. Click the hinge back into the panel in the cupboard.

12

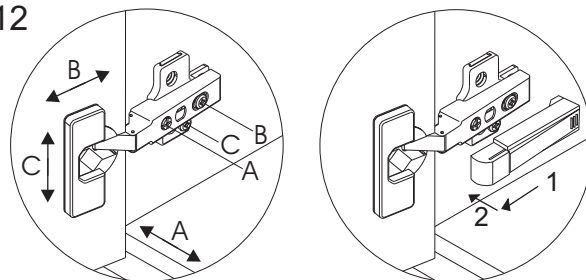

Adjust the doors, if desired:
A: adjusting the joints, horizontal positioning,
B: adjusting the depth,
C: adjusting the height.
Finally, place the damper on the hinge.